

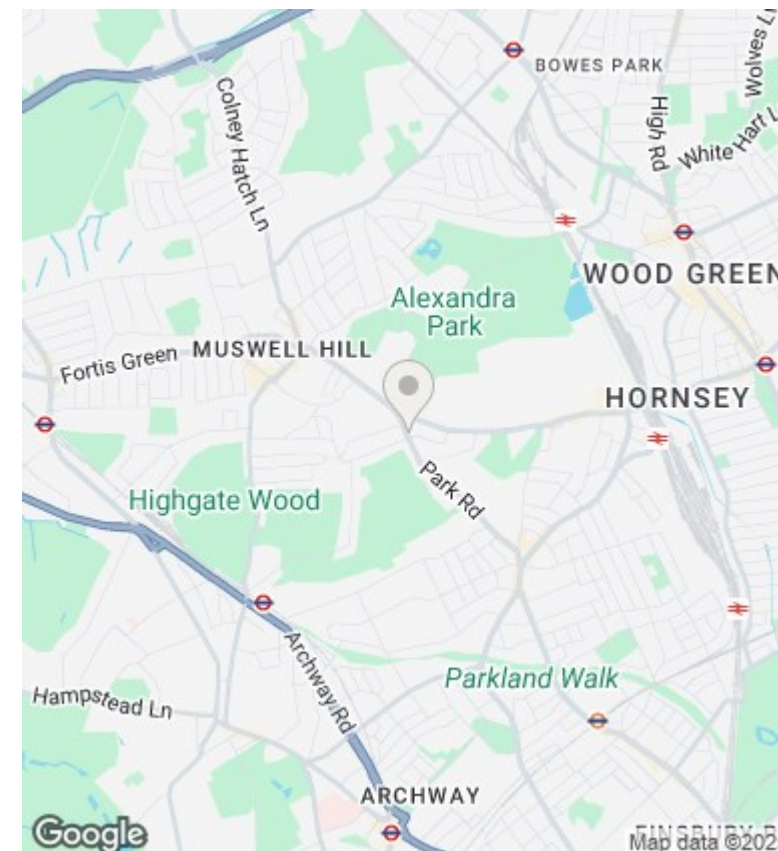

Park Road, London, N8 8LA

£1,750 PCM

- Second floor 2 bedroom flat above commercial premises
- Close to Priory Park, Muswell Hill and Crouch End vast array of shops and amenities
- Council tax band C - £1,962.61pa
- ***Not suitable for sharers***
- Fitted kitchen with appliances
- Fitted blinds throughout
- Unfurnished
- Built in wardrobes to both bedrooms
- Available on long term tenancy
- Available from 2nd February 2026

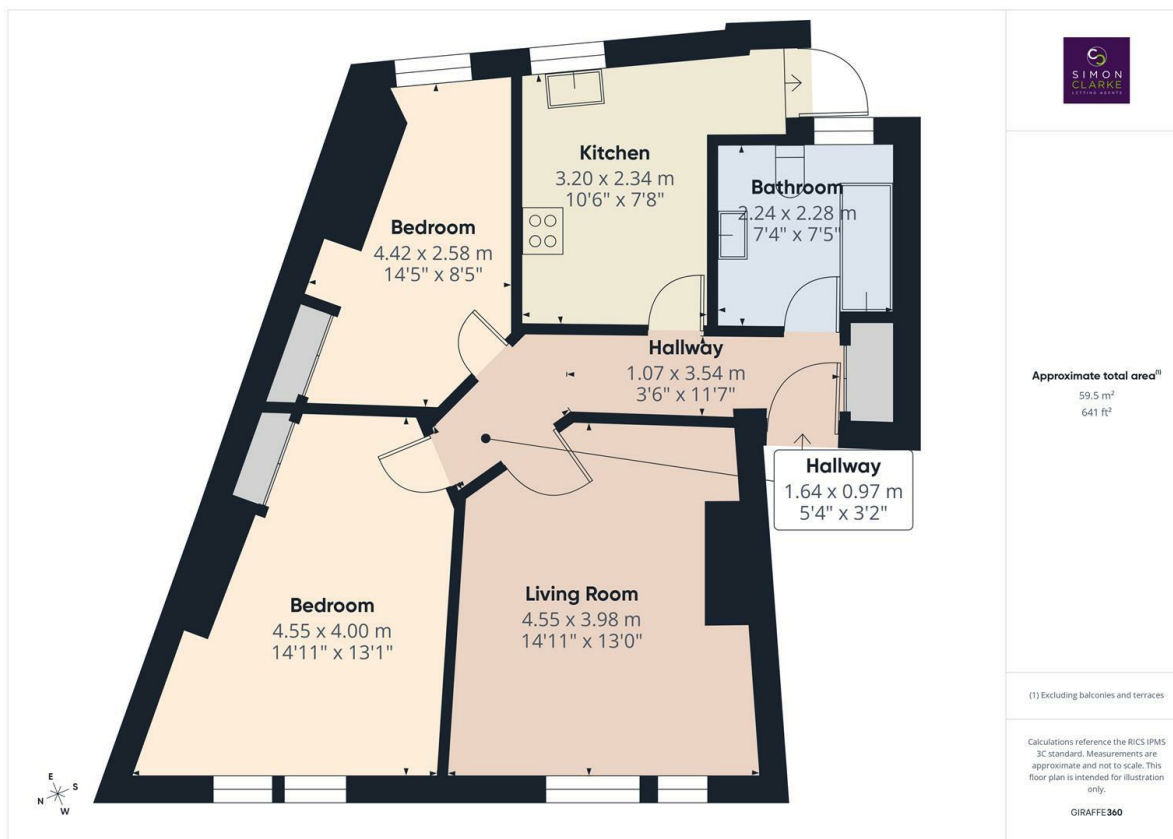

Directions

Viewings

Viewings by arrangement only. Call 02083499000 to make an appointment.

Council Tax Band

C

EPC Rating:

D

Energy Efficiency Rating		
	Current	Potential
Very energy efficient - lower running costs		
(92-plus) A		
(81-91) B		
(69-80) C		
(55-68) D	60	66
(39-54) E		
(21-38) F		
(1-20) G		
Not energy efficient - higher running costs		
England & Wales	EU Directive 2002/91/EC	